

780~890nm PM Circulator

Description

The high power PM circulator is characterized with low insertion loss, high extinction ratio, high isolation, high power handling, high return loss, excellent environmental stability and reliability. They are ideal for fiber laser and instrumentation applications.

Applications

- * Fiber Laser
- * Fiber Sensor

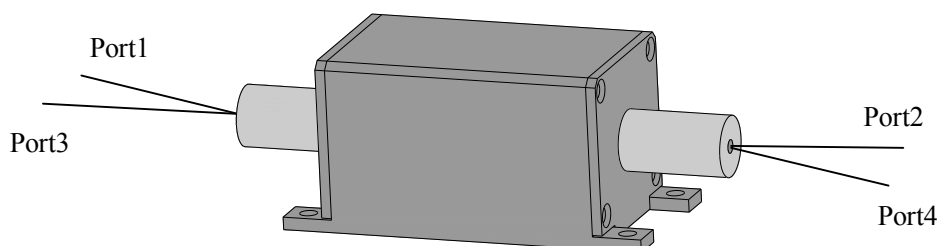

Specifications

Type Parameter	High Power		Low Power	
	3 Port	4 Port	3 Port	4 Port
Operating wavelength(nm)	780、808、850 or customized			
Bandpass(nm)	±10			
Insertion loss in bandpass at 23℃(dB)	≤1.7	≤2.0	≤1.5	≤1.8
Band of isolation(nm)	±5			
Isolation in band at 23℃(dB)	≥25			
Typical Peak isolation (dB)	≥28			
Extinction ratio (dB)	≥20			
Return loss (dB)	≥45			
Fiber type (can be customized)	SM85-PS-U25D or PM780HP			
Input max. power handling (W)	10		0.3	
Dimensions (L x W x H mm)	108*27*27			
Operating temperature(℃)	-5 ~ +50			
Storage temperature(℃)	-20 ~ +70			

* For 3port type, input power of Port3 <0.3W;

* For 4 port type, the port 1 to 2, 2 to 3, 3 to 4 and 4 to 1 is pass; the port 2 to 1, 3 to 2, 4 to 3 is isolated.

* The precondition of above specifications is extinction ratio of system ≥25dB

* The Above specifications is without connector, the connector handle power ≤0.3W

* IL is 0.80dB higher, RL is 5dB lower and ER is 3dB lower for each connector added. The default connector key is aligned to slow

Mechanical Dimensions (Unit: mm)

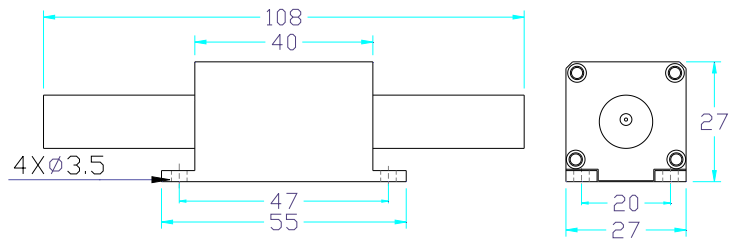

Ordering Information

PM CIR- X -XXXX-X-X-X(XX)- X -X*X*X- X

- Fiber length
- Package size: 108 x 27 x 27
- Average power handling: 300mW, 5W etc.
- Power condition: C=Continue Wave, P(5)=Pulse Peak Power(5KW),etc.
- Fiber type: SM85-PS-U25D, etc.
- Pigtail diameter: 0=bare fiber, 1=900µm, 2=2mm, 3=3mm
- Operating wavelength: 850nm etc.
- Port type: 3(3port) or 4(4port).