

635nm 0.5W Laser Diode | High Power 500mw LD

635nm LD 500mW High Power | TO 3 Package

WSLD-635-500m-3

Wavespectrum Laser, Inc.

www.wavespectrum-laser.com

| 635nm Laser Diode 500mw | | Wavespectrum Laser, Inc | |
|---|-----------|--|--------------|
| PARAMETER | SYMBOL | VALUE | UNIT |
| Reverse Voltage | V_r | 2.0 | V |
| Operating Temperature | T_{op} | +10~+25 | °C |
| Storage Temperature | T_{stg} | -40 ~ +85 | °C |
| Lead soldering temperature (10 sec.) | T_{is} | 280 | °C |
| Features: <ul style="list-style-type: none"> 635nm High power ,CW, Multi-mode High Quality TO3 package | |  | |
| Applications: <ul style="list-style-type: none"> Medical laser treatment Laser indicator Laser detector | | | |
| Specifications | | WSLD-635-500m-3 | |
| | | Min | Type |
| Center Wavelength@25°C | | 630nm | 635nm |
| Spectral Width (FWHM) | | | 1nm |
| Output Power | | | 500mW |
| Emitter Area | | | 100x1μm |
| Beam Divergence (FWHM) | | | 40°± x 10°// |
| Temperature Coefficient of Wavelength | | | 0.25nm / °C |
| Slope Efficiency | | 0.80W/A | 0.95W/A |
| Threshold Current (Typ.) | | | 0.75A |
| Operating Current (Typ.) | | | 1.20A |
| Operating Voltage | | | 2.2V |
| Package Style | | TO3/C-mount | |



Spectrum

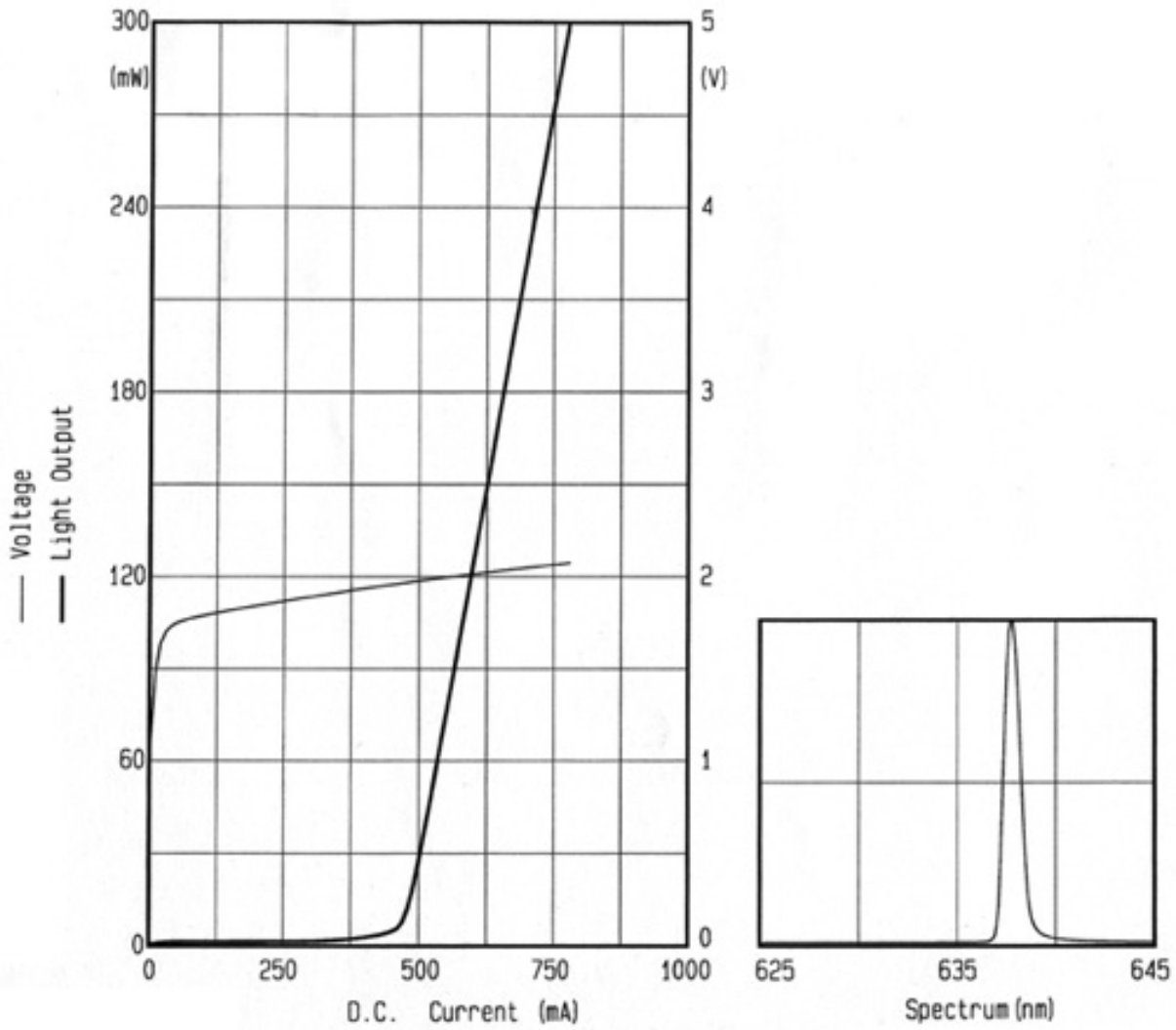

T03 Package View

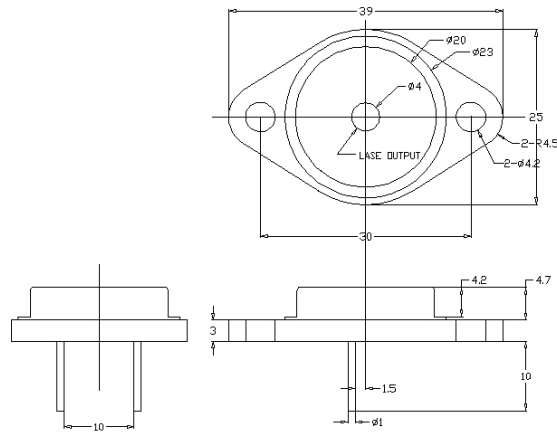

**Electrically shorten LD module and store in non-extreme conditions.
Suggest using the constant current power supply.**

