

1W 830nm high power LD with TO Can
830nm 1w laser diodes with TO 3 Package
WSLD-830-001-3 Wavespectrum laser inc.

www.wavespectrum-laser.com

830nm Laser Diode 1W		Wavespectrum Laser, Inc		
Reverse Voltage	V_r	2.0	V	
Operating Temperature	T_{op}	-10~+50	°C	
Storage Temperature	T_{stg}	-40 ~ +85	°C	
Lead soldering temperature (10 sec.)	T_{is}	260	°C	
Features: <ul style="list-style-type: none"> ● 830nm ● High power ,CW, Muti-mode ● TO3,C-mount package 				
Applications: <ul style="list-style-type: none"> ● Medical laser treatment ● Laser indicator ● Laser detector 				
Specifications		WSLD-830-001-3		
		Min	Type	Max
Center Wavelength@25°C		820nm	830nm	840nm
Spectral Width (FWHM)		3.0nm		
Output Power		1W		
Emitter Area		100x1μm		
Beam Divergence (FWHM)		36° _⊥ x 10° _{//}		
Temperature Coefficient of Wavelength		0.3nm / °C		
Slope Efficiency		0.9W/A		
Threshold Current (Typ.)		0.8A		
Operating Current (Typ.)		20A		
Operating Voltage		2.2V		
Package Style		TO3		



Spectrum

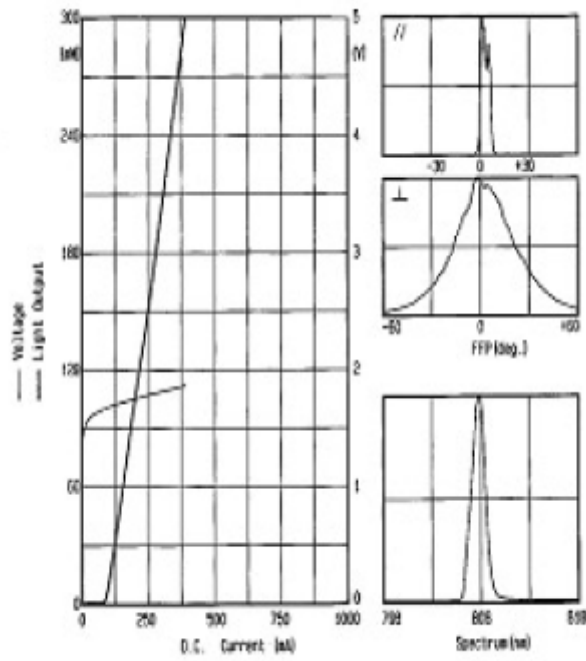

T03 Package View

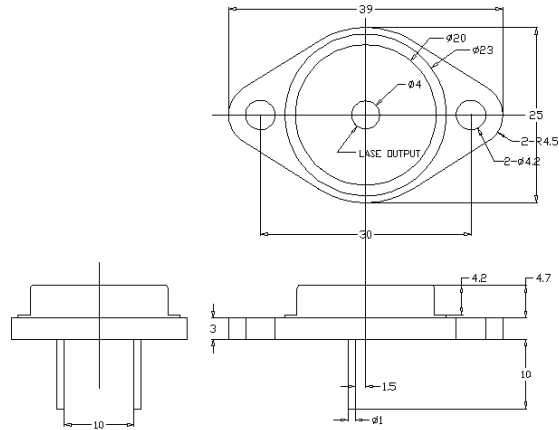

**Electrically shorten LD module and store in non-extreme conditions.
Suggest using the constant current power supply.**



Please contact us:

Website: www.wavespectrum-laser.com (for more detailed information)

Email: info@wavespectrum-laser.com (for inquiry about this product)

