

MRL-SF-612/1~100mW

**LD PUMPED ALL-SOLID-STATE
RED LASER**

CNI's DPSS laser at 612nm features ultra compact, long lifetime and easy operating, it is widely used in communication, medical treatment, scientific research, etc.



SPECIFICATIONS

Wavelength (nm)	612±1
Operating mode	CW
Output power (mW)	>1,10, 50, ... , 100
Power stability (rms, over 4 hours)	<3%, <5%
Transverse mode	Near TEM ₀₀
Beam divergence, full angle (mrad)	<2
Beam diameter at the aperture (1/e ² ,mm)	~4
Polarization ratio	>100:1
Beam height from base plate (mm)	100
Warm-up time (minutes)	<10
Operating temperature (°C)	15~30
Power supply (90-264VAC)	PSU-W-FDA
Expected lifetime (hours)	10000
Warranty period	1 year



MRL-SF-612

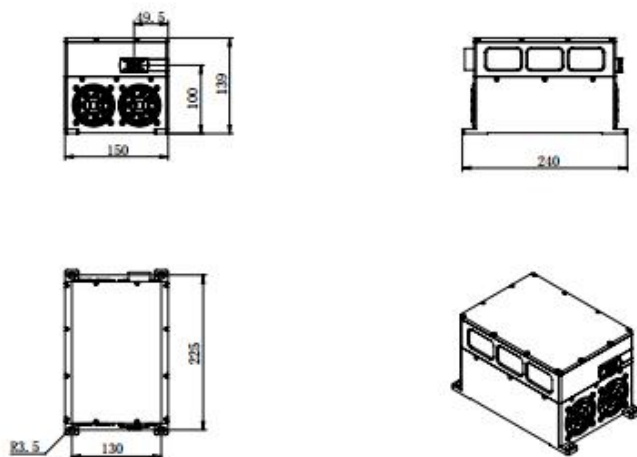

240(L)×150(W)×139(H) mm³, 7.5kg

PSU-W-FDA

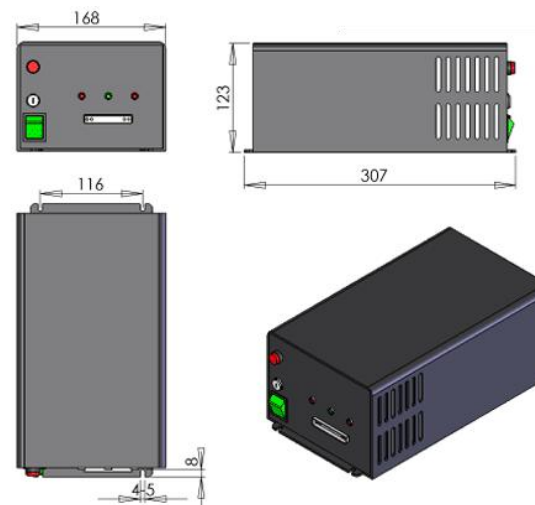

307 (L) ×168(W) ×123(H) mm³, 4.5kg