

TAP In-Line Isolators

In-Line isolation device for power monitoring output

CASTECH supplies TAP isolators which have a power monitoring port, exporting light in constant proportion of the output power for easier detection. It supports various output ratios like $0.1 \pm 0.05\%$, $1 \pm 0.5\%$, $2 \pm 0.8\%$, $5 \pm 1.0\%$ and $10 \pm 2.0\%$, of course, the ratio can be customized as well.

CASTECH produces TAP in-line isolators with high isolation, high power handling, high return loss, low insertion loss, excellent environmental stability and high reliability, The connection types of the fiber tail can be bare fiber or FC/APC.

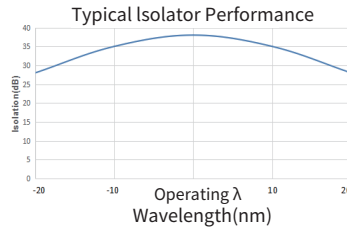
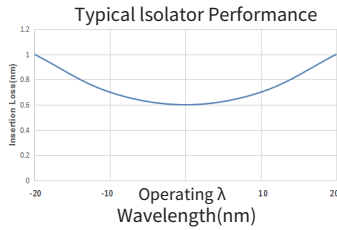

Applications

- EDFA
- DWDM systems
- Optical coherence detection
- Laser sensing
- Fiber

CASTECH's products are produced independently throughout the entire process and can be customized according to customer needs. Refer to the following list for standard products.

Non-Polarization-Maintaining Type Model Number: HPISO-t-p-f-λ-e-b-s-d-h							
Type (t)	Power (p)	Fiber Type (f)	Wavelength (λ)	Pigtail Diameter (e)	Fiber Length (l)	Filter (b)	Housing (h)
TAP (With monitoring port)	0.3-500 W	1 (HI1060) ...	980-1940 nm ...	L (900 μm Loose) Tube (3 mm Loose) Tube	1 (1 m) 2 (1.5 m) ...	C (Contained) N (Not Contained)	A15 A23 ...

Typical Specifications

Withstand Power	Extinction ratio*	Insertion Loss	Peak Isolation
10 W	>18 dB	≤1.2 dB	>30 dB
50 W	>18 dB	≤1.2 dB	>30 dB

* Only applicable to polarization maintaining TAP online isolators

Housing dimensions(mm):

A15

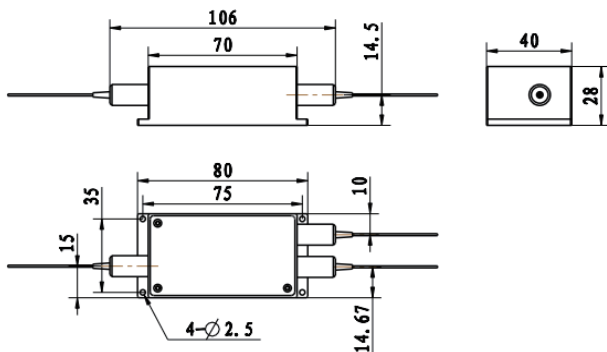

A23

